

THE TEXAS HIGH SPEED TRAIN

**CONNECTING PEOPLE, CREATING
JOBS & A NEW AMERICAN INDUSTRY**





WHAT MAKES THE TEXAS TRAIN DIFFERENT

A New Way to Connect

Reimagining Travel between North Texas and Houston



SAFE

Zero Accidents / Zero Fatalities

More than 53-years in operations in Japan

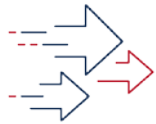

FAST

Travels at Nearly 200-Miles Per Hour

Houston to North Texas in 90-minutes



RELIABLE

Leaves On Time, Every Time

Less than a one-minute delay annually

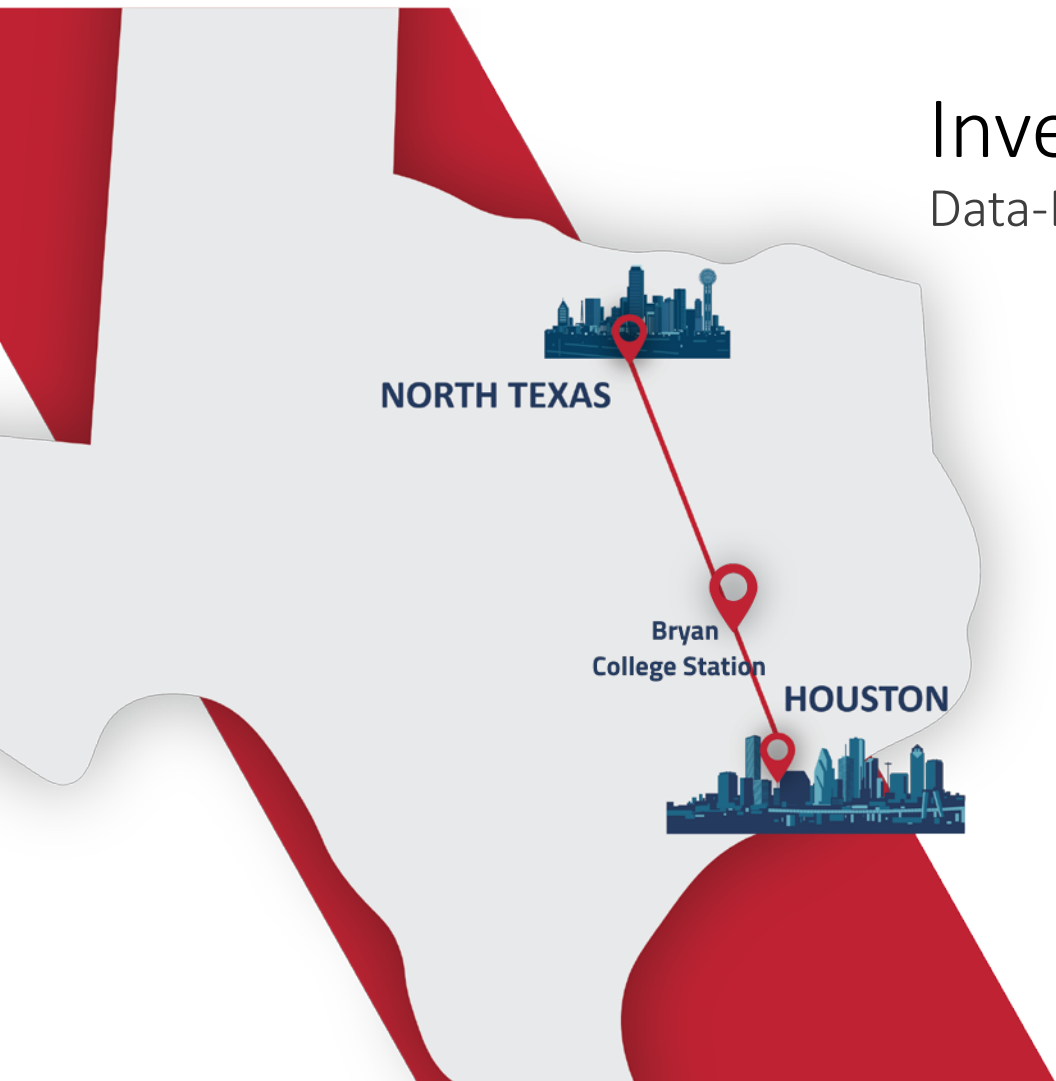

Investor-Owned Approach

Data-Driven Decisions



\$10s of millions spent on studies



16-million trips per year already being made



80% of Texans surveyed said they would consider riding the bullet train

Tracking Progress

The Train is Moving Forward

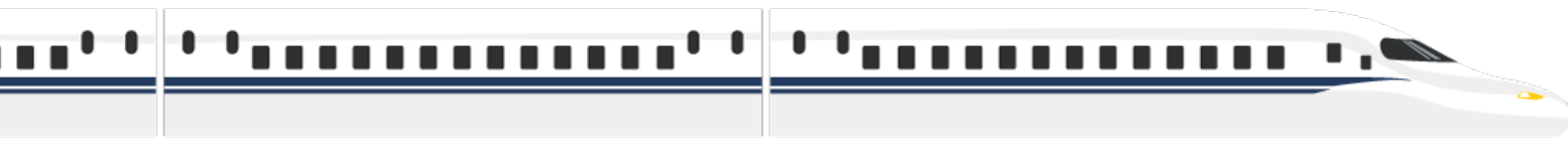

FEB 2011

Initial
Technical
Feasibility
Study
Validates
Concept

JUN 2014

Environmenta
l Review
Process
Begins

JUL 2015

Texas-based
investors fund
\$75 million
capital raise

AUG 2017

Fluor and
Lane
Announced as
Design/Build
Partner

DEC 2017

DEIS is
Released
By FRA

MAY 2018

Bechtel
Named Project
Manager



BUILDING THE
TRAIN EVERY DAY

Construction on a Texas-Sized Scale

>\$12 Billion Investment in Civil

Infrastructure



CONCRETE

10 million cubic yards of concrete, nearly 3X used in the Hoover Dam



RAIL

Nearly 1,100 miles of rail



STATIONS & FACILITIES

3 passenger stations
2 train maintenance facilities
multiple maintenance of way and power substations

Jobs, Jobs, Jobs

10,000 Direct Jobs per year During Construction



Electrician
\$42,000/year



Welder
\$50,000/year

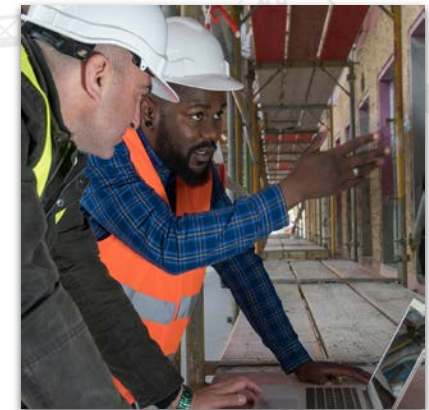

Construction Manager
\$80,000/year

Source for salaries: *Texas Workforce Commission*

Creating a New Industry in Texas

The Texas Train is Moving Forward

More than 1,500 Direct Jobs Once Operational



Building Relationships While Building the Train

The Texas Train is Moving Forward

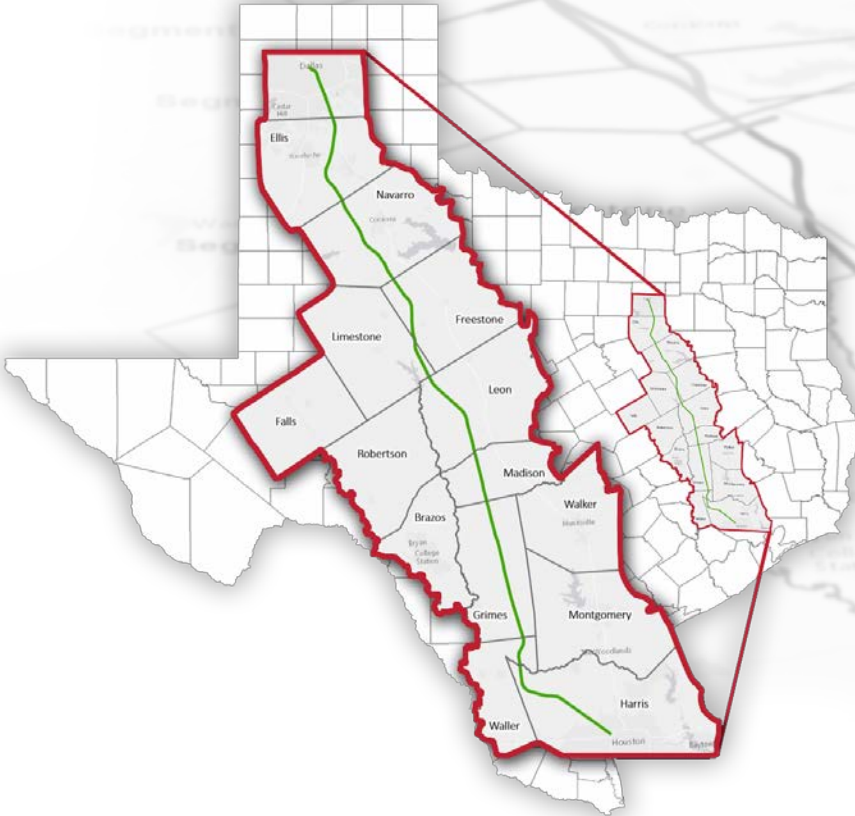

“I’m certainly in favor of it, if it could save one life.”

Terry, Grimes County Resident



“It was strictly a win-win situation for us, and I think for Texas.”

Debra & Johnny, Madison County landowners



“It’s a great opportunity for Texans to travel our state.”

Alicia, Grimes County property owner



GOOD FOR TEXAS
AND THE U.S.

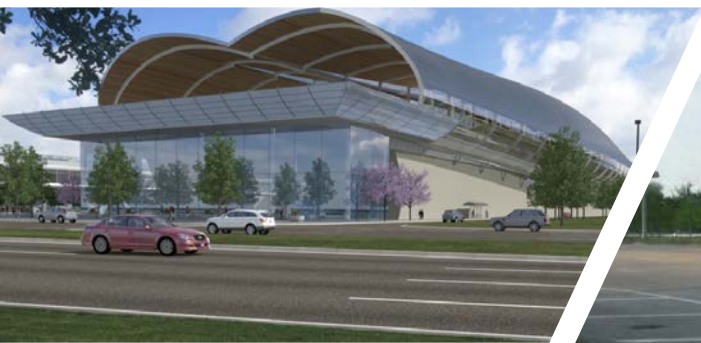

Houston Station Creates Jobs, Revitalization



Transportation
Connectivity



Road Improvements
Planned



Job Creation



Boosting the Brazos Valley Economy



124

Full-time jobs created
once in operation



+\$1,000,000,000

Total amount invested in
Grimes County alone during
the project's construction

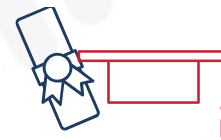

80,000

Estimated number of
college students in
the service area

North Texas Station

A Catalyst for Growth

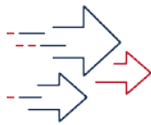

High Speed Hub



Neighborhood Transformation



Job Creation



North Texas



Northwest Houston



Brazos Valley



Benefits Spread Across the State

Jobs, Revenue and Opportunity for Texas

\$36B

In Economic Impact

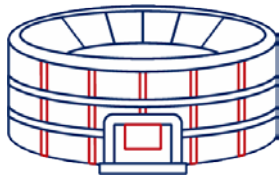

Equivalent to
84 Super Bowls

25%

Of Permanent Jobs
In Rural Communities

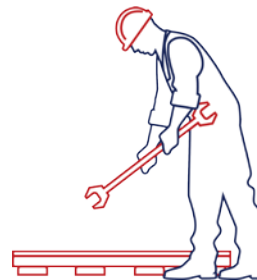

10

Counties



First Responders
Training & Equipment

The Train Creates Super Economy

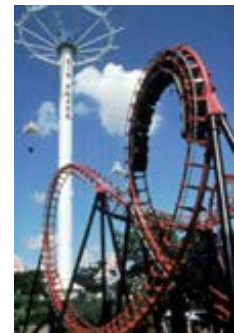

Smarter, Faster Way Across Texas



Join Us to Stay Informed

Text TRAIN to 52886



Share Your Feedback at
info@TexasCentral.com

www.TexasCentral.com